

A large, stylized number '8' logo in a dark blue color, centered in the background. The '8' is composed of two thick, rounded strokes that meet at the top and bottom, creating a central void.

Pearl
House

Project Description



Pearl House Projects, all lie at the heart of Larnaca city and constitute equivalent features with design variations on the façade. The projects provide the same exceptional quality workmanship and satisfy all the needs, stated and implied as defined by the most exacting market.

Pearl House 8, a true in-city exclusive block of eight luxurious apartments, invites comfort and modern elegance reflecting the personality of the consumer accustomed to the best in quality and design. Centrally located, 800m from Finikoudes promenade and 200m from the Larnaca New Marina, in an area going through a major upgrade, Pearl House 8 is close to self-serving shops,

food stores and schools. Cleverly designed for supporting maximum privacy, the project boasts six 2-bedroom and two 3-bedroom apartments all with an ensuite, appealing floors and decorative ceilings flowing throughout each home's open, airy layout. Pearl House 8 features marble staircases, security tele-screen intercoms, private parking and storage room. Full energy efficiency standards are met through the quality management process during construction, ensuring environmental sustainability.



DESIGN & LIFESTYLE

Design

The nature of the design of Pearl House 8 is one of well-executed style which gracefully embraces the natural curvature of the surrounding land. The prominence of the project's location at the intersection of two streets, is reflected in the design which defines the street corner effecting a sharp distinction of a breathing façade. The apartments on the third floor and floors above, enjoy delightful sea views whereas the top floor apartment prides itself on the inspiring rooftop terrace complemented with a swimming pool; the perfect setting for relaxing and entertaining. Connected through private interior and exterior staircases, the roof terrace avails generous service and storage rooms and wonderful views.



Private Lifestyle

The modern design and airy elegance of Pearl House 8, enhance a relaxed mood in the open plan living areas which make the most of the natural light, keeping interiors vibrant and lively. Minimal front guardrails on the balconies, the perfect chill-out niche, give a light appearance allowing views through them whilst the roof terrace, transformed into a beautiful garden, becomes the favourite place for al fresco dining.

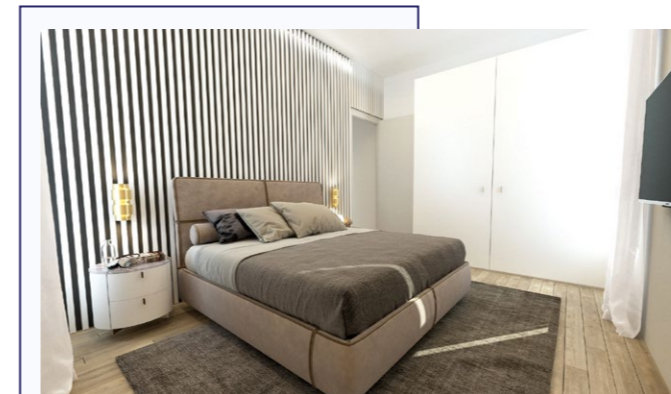

Specifications

TWO BEDROOM APARTMENTS

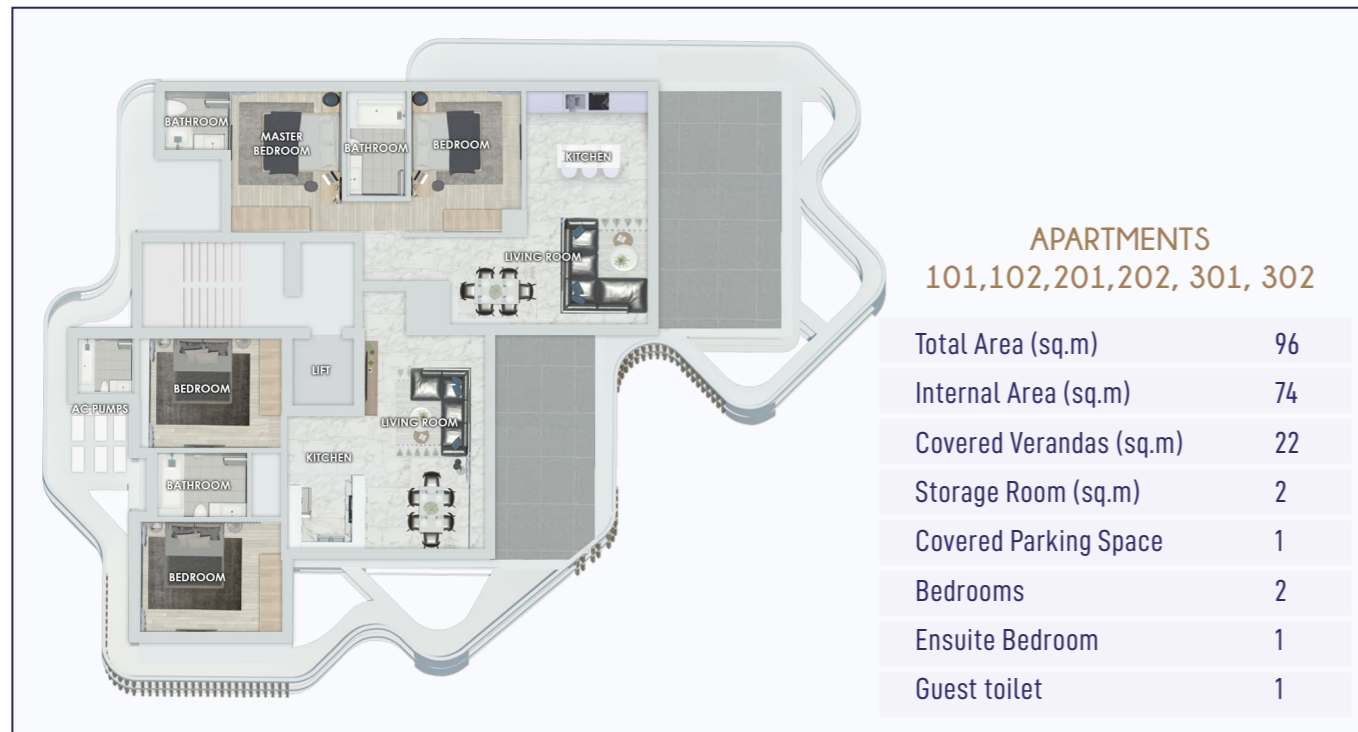

THREE BEDROOM APARTMENTS

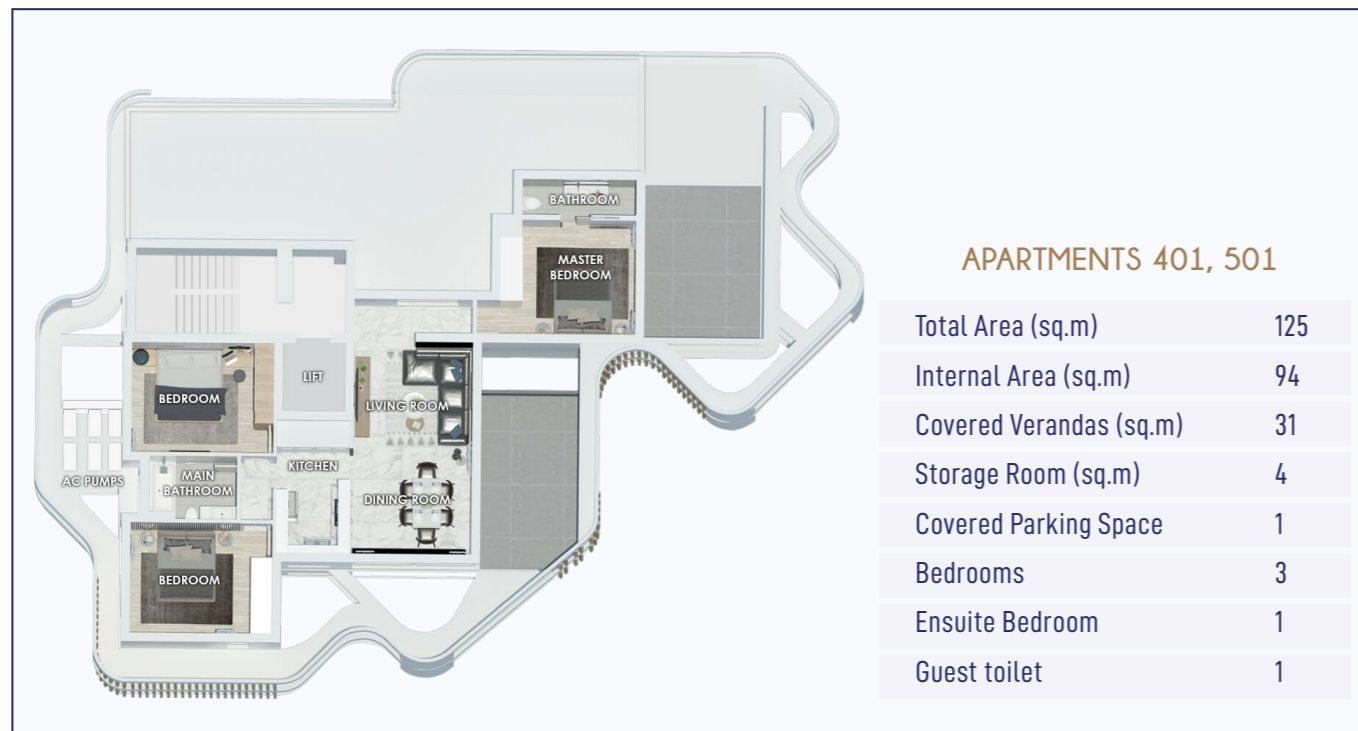

About The City

Beautifully compact, easily accessible and truly authentic, Larnaca is Cyprus' oldest soul; the longest continually inhabited region of the island, with a history that dates back 10,000 years. Presently considered to be the upcoming centre of the island, the town has been seeing some major investments both in infrastructure and ongoing development.

the best of all worlds. A characteristic feature of the region is that there is no distinction between resort and town; locals and visitors alike can enjoy the same daily experience of a charming and diverse Mediterranean city. From stretches of varied coastline, a mix of traditional and cosmopolitan establishments and fascinating monuments, Larnaca seamlessly blends its two 'faces'.

Whilst it is rich in the ancient culture of hundreds of years of contrasting civilizations and architecture, Larnaca is also a thriving and modern European city that offers

Information on Larnaca can be found on the Larnaca Tourism Board official site.

Notes:
 1. Figures are an approximate calculation and rounded off the nearest one-meter square.
 2. The data outlined in this table is for information purposes only and does not constitute an offer or a contract.
 3. Apartment 501, on the top floor, is connected to a private rooftop terrace complemented with a swimming pool.





Pearl
House